

InLighten™ Light Shelf

Reducing Artificial
Lighting Needs



211 North Front Street Office Building, Harrisburg, PA
Architect: Murray Associates Architects, P.C., Harrisburg, PA
Glazing Contractor: Hershocks, Inc., Harrisburg, PA
Photo courtesy of Murray Associates Architects, P.C.

InLighten™ Light Shelf is a series of standard design elements that are assembled to passively channel natural daylighting into an occupied space. Kawneer's light shelf features an extruded aluminum chassis system and Aluminum Composite Material (ACM) panel surfaces. Assembled and erected, these components serve as an interior extension to a curtain wall horizontal, reflecting sunlight deeper into the interior of a building by "bouncing" natural light up

to the ceiling. Architectural light shelves have been proven to reduce requirements for perimeter artificial lighting, thereby conserving electrical energy costs. The InLighten™ Light Shelf represents another Kawneer solar control product solution, and is designed for integration with other Kawneer products.

Single Source Responsibility

InLighten™ can be attached directly to Kawneer's 2-1/2-inch profile curtain walls – 1600 Wall System®1 (outside glazed), System®2 (Structural Silicone Glazed), System®3 (inside/outside glazed) and System®5 (inside glazed).

Applications integrating InLighten™ with 1600 Wall System®1 and 1600 Wall System®5 can provide dual energy savings by incorporating 1600 SunShade®. On elevations with direct sunlight, the sunshade is designed to filter sunlight at the floor perimeter while the light shelf redirects sunlight deeper into the occupied space.

Aesthetics

Standard InLighten™ components incorporate considerable design flexibility:

- ACM panel surfaces are lightweight and available painted in a number of colors
- Extruded components can be painted or anodized
- Two options are available – the fascia cap and the continuous panel, which is also known as "Rout and Return"
- End caps have been designed to allow for punched window applications
- Custom fascia cap profiles can be developed

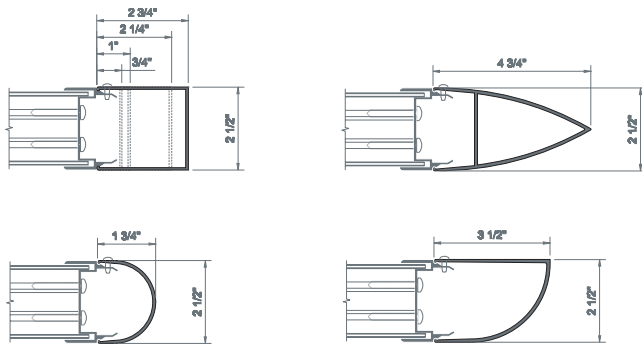

Fabrication

InLighten™ is field fabricated from stock length material. It is economical, lightweight and is easy to install and assemble. Screw-spline joinery is used for assembly of the shelf.

When InLighten™ is attached to 1600 Wall System®3 and System®5, outside glazed horizontal members are used for attachment strength.

For the Finishing Touch

Permadonic Anodized finishes are available in Class I and Class II in seven different colors.

Painted Finishes, including fluoropolymer that meet or exceed AAMA 2605, are offered in many standard choices and an unlimited number of specially-designed colors.

Solvent-free powder coatings add the "green" element with high performance, durability and scratch resistance that meet the standards of AAMA 2604.

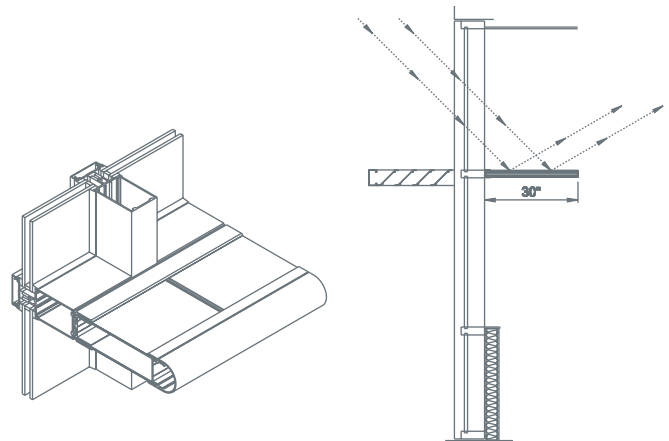

Kawneer Company, Inc.
Technology Park / Atlanta
555 Guthridge Court
Norcross, GA 30092

kawneer.com
770 . 449 . 5555

 **KAWNEER**
AN ALCOA COMPANY

