

1600 Wall System®1 / System®2

Imposing Statements –
Used Together
Or Independently



Knight Oil Tools Corporate Facility, Lafayette, LA
Architect: Donald J. Breaux Architect, Lafayette, LA
Glazing Contractor: Advantage Glass & Mirror, New Iberia, LA, with
installation assistance from DeGeorge Glass Company, Inc., Metairie, LA

Building on the proven success of Kawneer's 1600 Wall System® which set the standards for curtain wall engineering, 1600 Wall System®1 and 1600 Wall System®2 provide reliability with versatile features. Both are stick-fabricated, pressure glazed curtain walls for low-to-mid-rise applications and are designed to be used independently or as an integrated system to provide visual impact for almost any type of building.

- 1600 Wall System®1 is an outside glazed, captured curtain wall
- 1600 Wall System®2 is a Structural Silicone Glazed (SSG) curtain wall

Aesthetics

Even the smallest details of 1600 System®1/1600 Wall System®2 reflect the aesthetics and reliability that derive from Kawneer's precise engineering and experience. The joinery for both systems is accomplished with concealed fasteners to create unbroken lines and a monolithic appearance. When using optional, open back horizontal mullions, the fillers snap at the edge, producing an uninterrupted sight line.

Performance

Key aspects of 1600 System®1 and 1600 Wall System®2 are enhanced for higher performance. Pressure equalization has been designed into the system and all components are silicone compatible to provide superior longevity. For installations where severe weather conditions are prevalent, 1600 Wall System®1 has been large missile hurricane impact and cycle tested. Proven through years of high performance, both systems are tested according to industry standards:

Air Performance	ASTM E-283
Static Water Penetration	ASTM E-331
Dynamic Water Penetration	AAMA 501.1
Structural Performance	ASTM E-330
"U" Value, CRF	AAMA 1503.1
Sound Transmission Rating	ASTM E 90-90
Seismic Performance	AAMA 501.4

For the Finishing Touch

Permadonic Anodized finishes are available in Class I and Class II in seven different colors.

Painted Finishes, including fluoropolymer that meet or exceed AAMA 2605, are offered in many standard choices and an unlimited number of specially-designed colors.

Solvent-free powder coatings add the "green" element with high performance, durability and scratch resistance that meet the standards of AAMA 2604.



Hunter Henry Center at Mississippi State University,
Mississippi State, MS
Architect: Foil Wyatt Architects & Planners, P.A., Jackson, MS
Glazing Contractor: American Glass Company, Inc., Columbus, MS

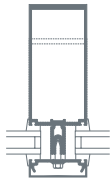

1600 Wall System®1

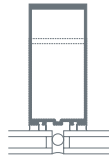

1600 Wall System®2

1600 Wall System®1/1600 Wall System®2:

- for reliability
- for performance
- for versatility
- for a smooth, monolithic appearance
- for uninterrupted sight lines

Kawneer Company, Inc.
Technology Park / Atlanta
555 Guthridge Court
Norcross, GA 30092

kawneer.com
770 . 449 . 5555

 **KAWNEER**
AN ALCOA COMPANY

